

## FLOORING INSTALLATION INSTRUCTIONS

### TAJ RIGID CORE CLICK



TAJ Rigid Core Click is an engineered vinyl plank flooring that uses no adhesive to bond the vinyl layers together and features the patented I4F interlocking planks profile for easy installation and is installed as a glueless floating floor. The interlocking planks lock together to provide a tight water-resistant joint. TAJ Rigid Core Click floors can be installed over most floor surfaces and are suitable for both residential and light commercial interior applications. For technical information or question, contact TAJ Customer Service:

(888) 652-2111 | [info@tajflooring.com](mailto:info@tajflooring.com)

#### General Information:

1. Flooring should be transported and stored in a neatly stacked fashion on a smooth flat surface. Be sure to inspect the run numbers/production dates on the boxes as different runs may be slightly different, once installed it becomes the installer's responsibility.
2. Maintain a constant temperature between 50° and 100°F before, during, and after installation.
3. Acclimation is not required unless the material has been exposed to extreme temperatures (under 50 degrees F or over 100 degrees F) for over two hours. If the product has been exposed to these low or high temperatures, allow the product to acclimate to temperature-controlled room temperature.
4. A constant substrate and ambient room temperature must be maintained between 50-100 degrees F continuously for 48 hours prior to and during installation. A constant humidity level between 35-65% should be maintained as well during the same time period.
5. Engineered Vinyl Planks should only be installed after other trades have finished and the jobsite has been cleaned and cleared of debris that could potentially damage a finished plank installation.
6. Inspect flooring for damage, defects, or shading issues before installation; claims for visual defects will not be accepted after materials are cut and/or installed.
7. Mix and install planks from several different cartons during installation to ensure a random appearance.
8. Leave 1/4 inch (6.35mm) for expansion around the **entire** perimeter of the flooring.
9. Transition moldings are recommended in rooms that have dimensions exceeding 100 lineal feet.
10. Flooring should be protected from direct exposure to UV light by using shade or blinds as necessary.

#### Subfloors:

Planks can be installed over a variety of subfloor surfaces including concrete on all grade levels, wood and many other existing hard surface floors. The subfloors must be clean, dry, smooth, flat, and solid (no movement).

**Do not install planks over floors that are sloped for drainage.** Any uneven areas greater than 3/16 inch in a 10-foot radius should be leveled with a Portland cement based patching compound. TAJ Rigid Core Click is impervious to water damage, but they do not prevent the transmission of moisture. Care should be taken to keep moisture from collecting on either side of the flooring to prevent the growth of unhealthy mold and mildew.

#### Concrete Subfloors:

Planks that are to be installed over concrete on all grade levels; a moisture barrier is recommended but not required and should consist of a minimum 6 mil polyethylene film with sheets overlapping 6" and taped to prevent substrate moisture migrating to the flooring. Moisture vapor emissions should not exceed 5 lbs./24 hour per 1,000 sq. when tested with the Anhydrous Calcium Chloride Test in accordance with ASTM F 1869 or 85% RH in accordance with ASTM F 2170 "Standard Test Method for Determining Relative Humidity in Concrete Slabs using in situ Probes. Any uneven areas greater than 3/16" in a 10-foot radius should be leveled with a Portland cement based patching compound. Holes and cracks in the cement should be patched, and expansion joints should be filled with a latex patching compound. Newly poured concrete floors must cure for a minimum of 90 days. Please note it is the person installing the floor and/or the homeowner's responsibility to ensure any moisture or alkalinity issues are resolved prior to installing the floor.

**NOTE: Excessive moisture may cause the growth of unhealthy mold or mildew and/or cause staining of the flooring which is not covered by our Warranty.**

**Wood Subfloors:**

Planks can be installed over a smooth, flat, level wood subfloor, underlayment grade plywood, lauan plywood and other underlayments recommended by the specific manufacturer as appropriate for use with a floating plank floor. The subfloor should be flt within 3/16 inch in a 10-foot radius. Wood subfloors must be suspended at least 18" above the ground. Adequate cross-ventilation must be provided, and the ground surface of the crawl space should be covered with a suitable vapor barrier. If installing over a crawl space, a minimum 6 mil polyethylene moisture barrier must be used.

**NOTE: Avoid subfloors with excessive vertical movement or deflection because subfloor movement may cause the locking mechanism to wear down, or even break. Indications of excessive deflection are subfloor fastener release, squeaking, compromised or sectional contours such as bowing or dipping in floors and uneven flooring material. Nail or screw subfloor panels to secure boards with excessive vertical movement or deflection prior to installation of the flooring material. Our warranties DO NOT cover any problems caused by inadequate substructures or improper installation of substructures.**

**Existing Flooring:**

TAJ Rigid Core Click can be installed over a variety of finished floors including single layer resilient sheet flooring/ tile, ceramic, marble and terrazzo. The surface must be in good condition and show no signs of excessive moisture conditions. Grout joints and heavy embossing in tile or vinyl must be leveled so they are flush with the flooring surface. The existing flooring may require several skim coats to achieve a flat surface. Carpet, heavily cushioned vinyl floors or vinyl floors consisting of multiple layers are NOT a suitable subfloor for installation.

**Radiant Heat Subfloors:**

TAJ Rigid Core Click can be installed over floor where radiant heating systems are present provided the subfloor surface does not exceed 85°F (29.44°C) at any point. The initial floor temperature should not exceed 70°F (21.11°C) for 24 hours prior, during, and 48 hours after installation. Thereafter the temperature should be gradually increased to the desired setting up to 85°F (29.44°C). Because heat does affect plastic more than wood, you may need additional room for expansion (larger perimeter expansion gap) and contraction (wider base to allow for contraction) Radiant heating systems that are installed on top of the subfloor surface and covered with self-leveling underlayment are not recommended.

**Important Notes:**

**Before removing any existing resilient flooring or tiles, please consult with a flooring professional to determine if asbestos abatement is necessary to avoid exposure. See current edition of the Resilient Floor Covering Institute (RFCI) publication "Recommended Work Practices for Removal of Resilient Floor Coverings" for detailed information and instructions on removing all resilient covered structures.**

**TAJ Rigid Core Click LV DOES NOT contain asbestos or crystalline silica.**

**Moisture Barrier and Underlayment:**

While it is not necessarily difficult to install a floating floor, you may want to consider having it done by a professional installer. For concrete substrates on grade or below-grade a moisture barrier of at least 6 mil polyethylene film with the sheets overlapping 6" and taped to prevent moisture migrating to the flooring is recommended but not required.

## INSTALLATION

Remove wall base and undercut door jambs. Do not secure individual planks to the subfloor as it is designed to be a floating floor. Do not install cabinets on top of TAJ Rigid Core Click flooring. Separate all rooms and any floors over 40ft x 40ft using T molding.

### Pre-Installation Inspection:

It is the responsibility of the person installing the floor to inspect all flooring before installation/placement. If during inspection the installer or owner feels the floors is the wrong color, improperly manufactured, has some visual defect, the flooring should NOT be installed. Please immediately contact the supplier from which the flooring was purchased. No claims will be accepted for flooring which is visibly wrong if such flooring is installed. Installed flooring is deemed to be visibly acceptable.

1. First, determine how you want the flooring to run. Typically for plank products, the flooring runs the length of the room. There may be exceptions since it is all a matter of preference.
2. To avoid narrow plank widths or short plank lengths near the walls/doors, it is important to do some pre- planning. Using the width of the room, calculate how many full boards will fit into the area and how much space remains that will need to be covered by partial planks.
3. Start with a whole plank in the left-hand corner of the room with the tongue side and end toward the wall. Lay the first row of planks along a chalk line and trim to fit to the wall allowing a 1/4-inch expansion space. If starting the first row with a whole width plank it will be necessary to trim the tongues next to the wall, then place the cut ends next to the wall. To trim the planks, use a utility knife and a straight edge to score the top surface of the plank, and then bend it downward to separate the pieces, you can also use a VCT (Vinyl Composition Tile) cutter for end cuts only; a table saw, or circular saw also works well for both end and length cuts.
4. Align and attach the end joints of the planks in the first row using the fold and lock method, the end joints should be tapped firmly using a tapping block on top of the end joint and tapping with rubber mallet until locked (Diagram 1a). For length joints insert the tongue into the groove while holding the plank at a 20° to 30° angle to the floor, apply pressure inward and down until the planks lock together (Diagrams 1b and 1c). Use spacers between the long edge and end of the planks next to the wall to maintain the expansion space. For each row the use of a rubber mallet with tapping block or scrap is recommended to ensure all joints are tightly assembled in each row. Do not hit the flooring directly with a mallet.

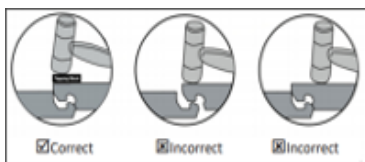

Diagram 1a

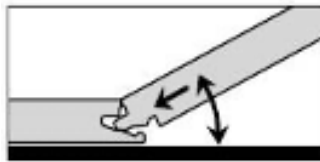

Diagram 1b



Diagram 1c

5. Start the second row using 1/3rd of a plank. Place the cut end against the wall. Insert the tongue on the long side of the plank onto the groove of the plank in the first row. Hold the plank in a 20° to 30° angle while applying pressure inward and down until they lock together (diagram 1a). Angle the plank and push the tongue onto the groove and adjust it until the tongue locks into place (diagram 1c). A tapping block may be needed for additional force. Complete the second row by inserting the length joints first and overlapping the end joints. Tap the length joint together using a tapping block or scrap flooring using light taps to fully engage the joint till flat and tap the end joint down firmly as explained in segment 4.
6. Start the third row using a 2/3rd length of a plank with the cut end against the wall. Complete each row thereafter using a random layout with end joints off-set by at least 8". Plan the layout to avoid using small planks (less than 6") at the walls. The cut piece at the end of the row can often be used to start the next row provided it achieves a random layout. Always place the cut end against the wall and allow for the expansion space.
7. TAJ Rigid Core Click planks are unique in that they can also be installed with a pull bar or tapping block and rubber mallet or hammer in difficult areas such as the last row, and when fitting under door trim. Use a pull bar and rubber mallet or hammer to lock the joints together in the last row. Always use a pull bar on the cut edge of the plank. Factory edges can be damaged if the pull bar is used directly against them.

## FLOORING INSTALLATION INSTRUCTIONS

### TAJ RIGID CORE CLICK

8. When fitting around the door trim it will be necessary to slide the plank under the trim. This can be accomplished easily by starting the row on the side of the room with the door trim and then sliding the plank into place once it is attached. The row can be completed by inserting the tongue onto the groove or the groove under the tongue depending on the direction. A tapping block and pull bar (**Diagrams 2a & 2b**) can also be used to lock the joints together while the planks are in a flat position. Use a series of light taps until the joint is gradually locked together.

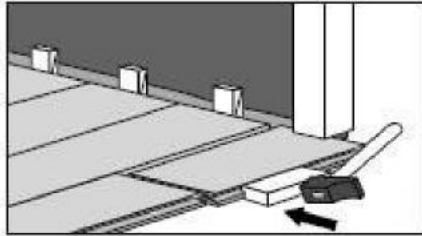

Diagram 2a

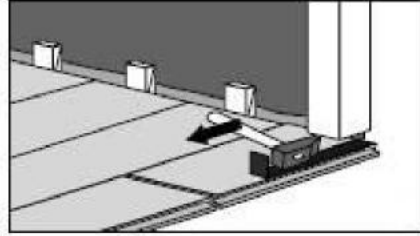
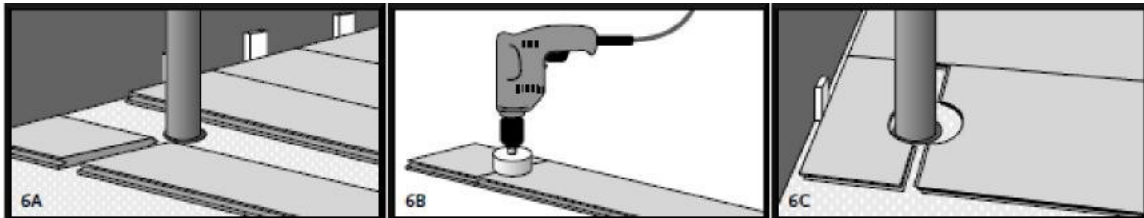

Diagram 2a

**Bathrooms:** When TAJ Rigid Core Click planks are installed in a bathroom the flooring should be installed around the toilet leaving a 1/8-inch (3.175mm) expansion space. Use 100% silicone caulking to fill the expansion space at the tub, shower and all wet areas to help prevent surface water seepage under the floor.

**Pipes:** In rows where there is a pipe or other vertical object through the subfloor, make sure the object lines up exactly where two boards will meet on the short ends. Take care to measure carefully before cutting, so the two boards end in the middle of the object. Use a drill or hole bit that is the diameter of the pipe or object, plus 1/2 inch for expansion/contraction. Click the two short sides of the boards together, then drill the hole centered on the joint between the boards as shown. Now you can separate the two boards and install as normal. See Diagrams 6A – 6C.



#### Transitions, Moldings, and Wall Base:

All transition pieces should be attached to the subfloor using the track supplied with the molding, or glue down using a contractor grade adhesive, dependent on the transition purchased. If adhered, be sure the transition sits firmly in the adhesive, and take care not to get any adhesive on the flooring. Remove any adhesive from the surface immediately per the adhesive manufacturer's instruction and buff off any residue with a dry soft cloth. It may be necessary to place heavy weights on the transition until the adhesive dries to ensure it will lay flat. Never attach the transitions directly to the flooring.

#### Finishing the Job:

Inspect the completed work, as it will cost more to return to the job site later if repairs are needed. Install baseboards to cover perimeter expansion gaps. It is not recommended or necessary to seal this floor after installation. Protect your floor from scratches by using felt pads on chair legs or furniture feet. Plastic rollers/castors can damage the new flooring, if necessary, try to replace with softer wheels/castors. When moving heavy items like refrigerators, use at least two sheets of 1/4" Masonite or plywood while moving (sliding the appliance from one sheet to the next) to protect the flooring against scratching and denting.

## GUIDELINES FOR USE

- Frequently moved furniture (chairs) should be equipped with felt pads to avoid scratching the floor and checked regularly. Heavy furniture and appliances should be equipped with non-staining large surface floor protectors. Furniture with castors or wheels must be easy swiveling, large surface non-staining and suitable for resilient floors. Do not use ball type castors as they can damage the floor.
- Avoid exposure to long periods of direct sunlight. Close blinds or drapes during peak sunlight hours
- Use non-rubber backed walk-off mats at entrances to prevent dirt and grit from being tracked on to the floor. Vacuum these mats regularly to limit the buildup of grit which could then be transferred to the Rigid Core Click Flooring.
- Sweep or vacuum the floor regularly to remove loose dirt.
- Clean up spills immediately.
- Damp mop as needed using clean water and a diluted neutral floor cleaner. Do not use harsh cleaners or chemicals on the floor.
- Consult TAJ Rigid Core Click Flooring Care Guide for more detailed maintenance instructions.

## REPAIRS

In the unlikely event that a plank is damaged for whatever reason, the simplest method is to disconnect the planks carefully (protecting the tongue and groove edges) until the damaged plank can be removed. Then replace the damaged plank with a new one and re-assemble the disconnected planks. This typically works for planks that are close to the two long perimeters of a room. For damaged planks that are not close to the perimeter, you may have to remove the damaged planks and insert new pieces without the short and long end grooves.

1. Using a sharp utility knife and a straight edge, cut out the center of the damaged plank by leaving approximately 1 inch (25.4mm) strip attached to the adjacent planks.
2. Carefully cut back from the four corners of the plank to the inside edges in space left by the cut-out plank.
3. Remove the plank edges carefully from of the adjacent planks making sure the tongues and grooves of the adjacent planks are not damaged.
4. Using a sharp utility knife, remove the tongue strip on the long end of the replacement plank. In addition, remove enough of the groove strip of the short end of the replacement plank to slip under the end joint.
5. Glue plank in place by using dabs of “super glue” or equivalent on the length groove every 3--4 inches prior to inserting the plank in place.
6. Position the replacement plank by engaging the groove of the long side into the tongue of the adjoining plank and pushing the end groove under the one end. The adhesive will hold the replacement plank in place with its adjacent planks.

